

BLOCK A CLASSROOM TRUNKING LAYOUT  
SCALE 1:100

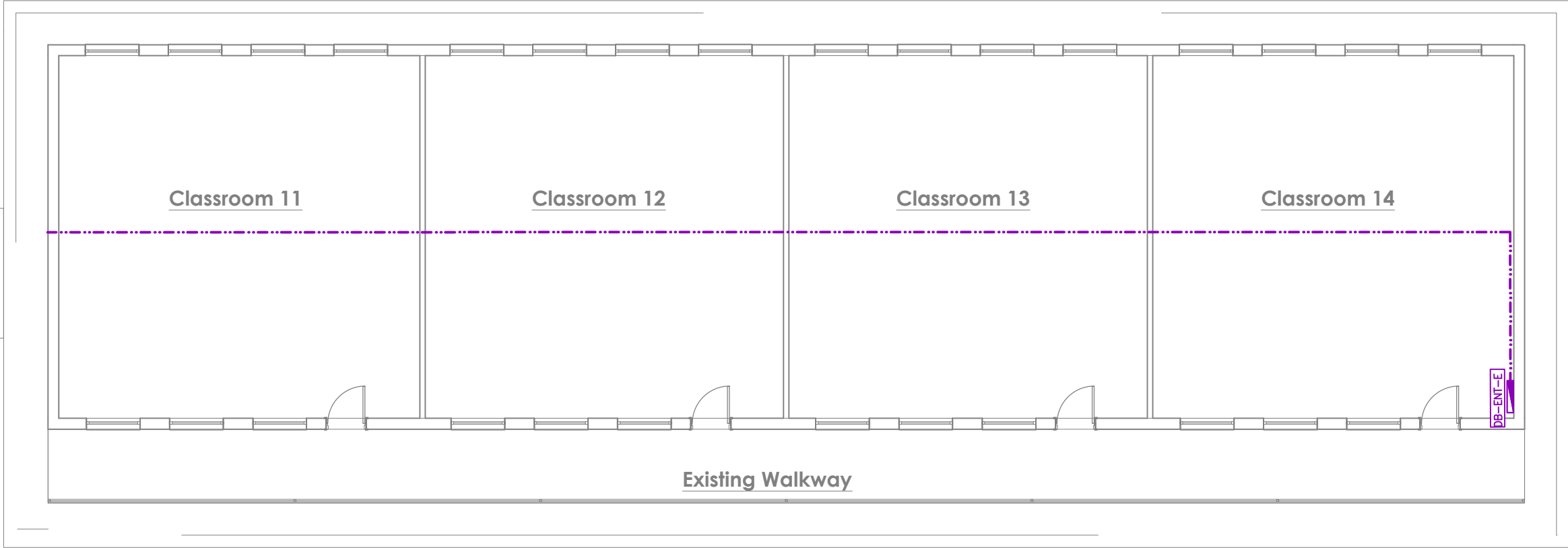

BLOCK E CLASSROOM TRUNKING LAYOUT  
SCALE 1:100

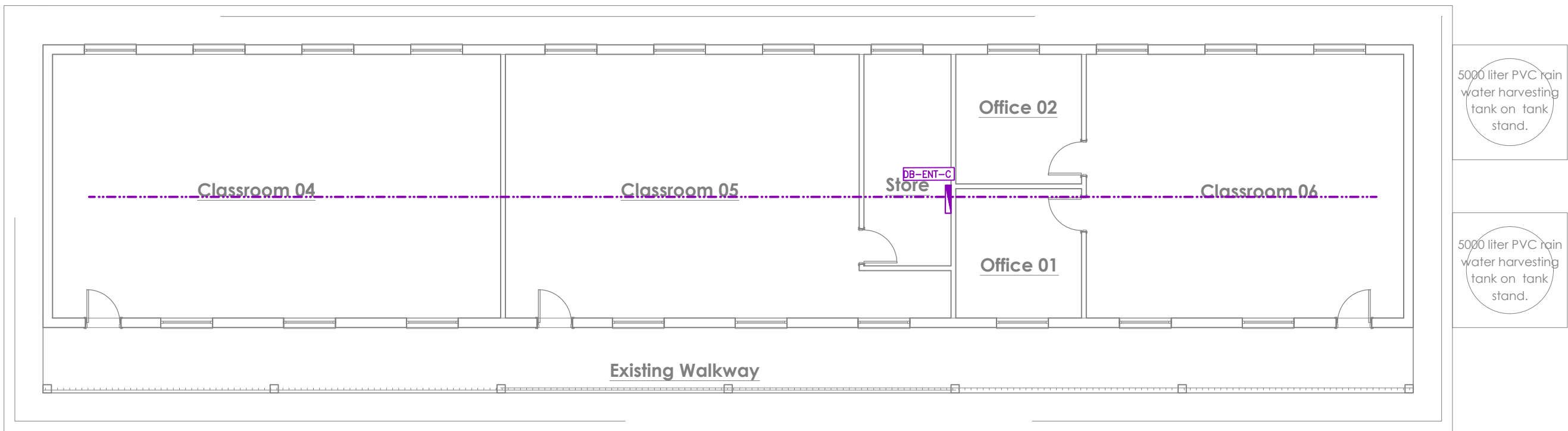

BLOCK C CLASSROOM TRUNKING LAYOUT  
SCALE 1:100

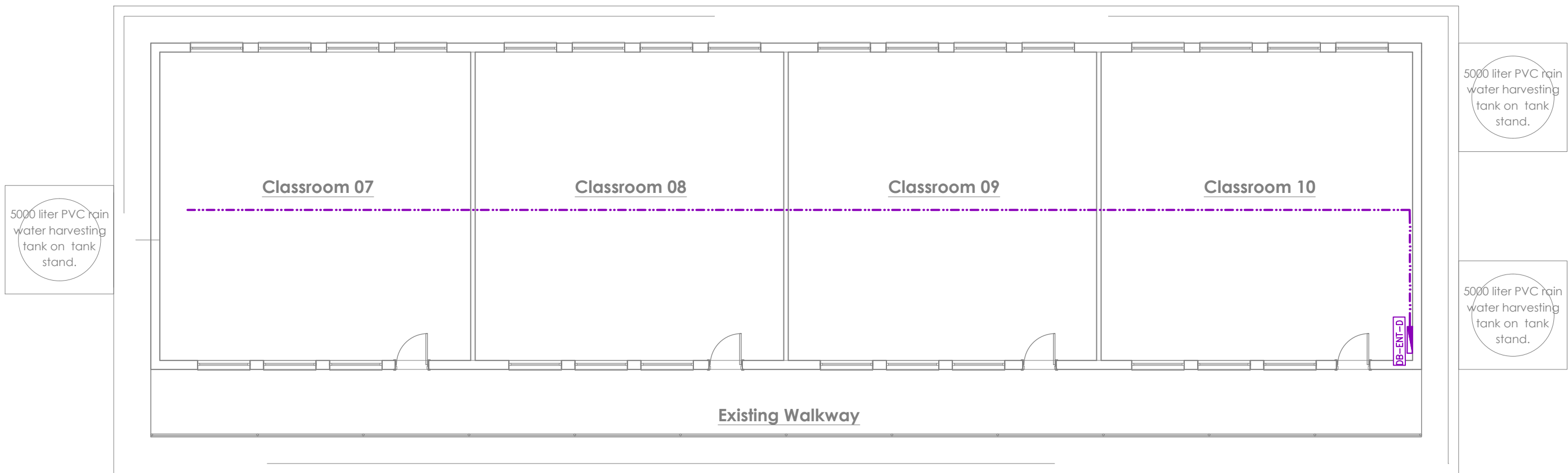

BLOCK D CLASSROOM TRUNKING LAYOUT  
SCALE 1:100

#### POWER LEGEND

NEW 16amp STANDARD SOCKET 3 PIN SWITCH SOCKET OUTLETS BEARING THE S.A.B.S. MARK. 16AMP 3-PIN NORMAL SSO's TO BE WIRED WITH 2.5mm P.V.C WIRE, 2.5mm B.C.E.W. IN POWERSWIRING. 20mm P.V.C CONDUIT IS TO BE INSTALLED TO ALL POINTS IN PARTITIONING. 20AMP S.P. 5KA CB IN DISTRIBUTION BOARD FOR PROTECTION. 6 X SSO's PER CIRCUIT.
NEW 16amp STANDARD SOCKET 2 PIN SWITCH SOCKET OUTLETS BEARING THE S.A.B.S. MARK. TO BE WIRED WITH 2.5mm P.V.C WIRE, 2.5mm B.C.E.W. IN POWERSWIRING. 20mm P.V.C CONDUIT IS TO BE INSTALLED TO ALL POINTS IN PARTITIONING. 20AMP S.P. 5KA CB IN DISTRIBUTION BOARD FOR PROTECTION. 6 X SSO's PER CIRCUIT.
NEW DOUBLE 16amp STANDARD SOCKET 3 PIN SWITCH SOCKET OUTLETS BEARING THE S.A.B.S. MARK. 16AMP 3-PIN NORMAL SSO's TO BE WIRED WITH 2.5mm P.V.C WIRE, 2.5mm B.C.E.W. IN POWERSWIRING. 20mm P.V.C CONDUIT IS TO BE INSTALLED TO ALL POINTS IN PARTITIONING. 20AMP S.P. 5KA CB IN DISTRIBUTION BOARD FOR PROTECTION. 6 X SSO's PER CIRCUIT.
DATA POINT - 100 x 100 DRAW BOX IN WALL, C/W BLANK PLATE OR IN DATA SECTION OF SKIRTING C/W BLANK COVER PLATE
TELEPHONE POINT - 100 x 100 DRAW BOX IN WALL, C/W BLANK PLATE OR IN DATA SECTION OF SKIRTING C/W BLANK COVER PLATE
DOUBLE POLE ISOLATOR
TRIPLE POLE ISOLATOR
3PH INDUSTRIAL SOCKET
P8000 TRUNKING FOR POWER AND LIGHTING
DISTRIBUTION BOARD

REV	DATE	BY	DESCRIPTION	CHK	APP
A	08.02.2023	T.T	ISSUED FOR INFORMATION	LL	LL

#### FOR INFORMATION

FUNDER:	 Department: EDUCATION PROVINCE OF KWAZULU-NATAL
IMPLMENTING AGENT:	 Development Bank of Southern Africa
PRINCIPAL AGENT:	 No. 7 Bush Shrike Close Victoria Country Club Estate 170 Porter Brown Drive Montrose/Pietermaritzburg 3201 Tel: 0333 347 7900 cell:maritzburg@mariswe.com
ARCHTECT:	 No. 18 Bushmans Road Durban Durban 4001 Tel: 031 261 1111 www.kwazulu-natal.co.za
ENGINEER:	 6, Scherwitz Road   Beria   East London Tel: +27 43 722 3353 Fax: +27 86 554 6496 info@karosolutions.co.za

PROJECT:  
**ENTUMENI PRIMARY SCHOOL,  
ESHOWE LOCAL AUTHORITY,  
uMLALAZI, 3830, KWAZULU-NATAL.**  
EMIS No:500138602

TITLE:  
**BLOCK A, C, D, & E CLASSROOMS  
TRUNKING LAYOUT**

SCALE @ A1: 1:100	CHECKED: LL	APPROVED: LL
CAD FILE: KS130-T01	DESIGN-DRAWN: T.T-T.T	DATE: 15.02.2023
PROJECT No: KS130	DRAWING No: KS130-T01	REV: A

© COPYRIGHT RESERVED  
The content of this document is privileged and confidential and may not be disclosed or reproduced without the express authorisation of the author, being "KARO SOLUTIONS"

#### GENERAL NOTES

- ALL DIMENSIONS TO BE CHECKED ON SITE BEFORE WORK COMMENCES.
- CONTRACTOR TO ENSURE THAT THE SCALE AS SHOWN ON THIS DRAWING RELATES TO ACTUAL CONDITIONS.
- TENDERERS SHALL ACQUANT THEMSELVES WITH THE LOCAL SITE CONDITIONS OF THIS PROJECT, SUCH AS ACCESS TO THE SITE, SIZE AND TYPE OF SITE, STORAGE SPACE, LOADING AND UNLOADING FACILITIES, SCAFFOLDING, TACKLES AND TOOLS NEEDED FOR THE ERECTION OF THE INSTALLATION, ADDITIONAL CLAIMS BY THE ELECTRICAL SUBCONTRACTOR, WHICH MAY ARISE FROM IGNORANCE OF THE SITE CONDITIONS WILL NOT BE CONSIDERED AND TENDERERS ARE ADVISED TO VISIT AND INSPECT THE SITE BEFORE SUBMITTING THEIR TENDER PRICE.
- ANY CONTRADICTION OF THESE PLANS MUST BE BROUGHT TO THE ATTENTION OF THE ARCHITECTURAL STUDIO.WORK FINISHES TO COMPLY WITH THE SPECIFICATIONS.
- REFER TO DETAILS AND NOTES ON THIS DRAWING WHERE SHOWN.
- WALL SOCKETS TO BE @300mm AFFL UNLESS OTHERWISE SPECIFIED.
- PLEASE READ THIS DRAWING IN CONJUNCTION WITH THE OTHER SERVICES DRAWING PRIOR TO THE INSTALLATION OF ANY WIRE MESH BASKETS OR P8000 TRUNKING INCLUDING POWER AND LIGHTING.
- FINAL LEVELS OF THE ABOVE SERVICES WILL BE DETERMINED BY THE LEVEL OF THE AIR CONDITIONING DUCT WORK.
- NO POWER SWIRTING TO BE FIXED TO ANY DESKS, DESKS ARE PROVIDED WITH CABLE CHANNEL UNDERNEATH TOP, CONTRACTOR WILL BE RESPONSIBLE FOR ANY DAMAGE TO DESKING.
- ALL LOOSE CABLING TO BE HELD TOGETHER WITH BLACK PVC SPIRAL CORDS.